

# Historic Resource Inventory - Whipple House

## Lakes Region Planning Commission - Bristol, New Hampshire

Created on May 10, 2011 at 7:30 pm by Sandra Heaney

Last updated on May 15, 2011 at 12:38 pm by Clay Dingman.

### Basic Data

Town	Bristol
County	Grafton
UTM	
USGS Quad	Bristol
Survey Number	18
Date	1904
Location	75 Summer Street
Owner	Sandra Heaney and Clay Dingman
Address	75 Summer Street, Bristol, NH 03222
Map and Parcel Number	114-051
Common Name	Henry Whipple House B&B
Historic Name	Whipple House
Functional Type	House
Present Use	Bed and breakfast
Architect/Builder	J.E. Randlett, Concord
Condition	excellent
Integrity	original site
Date Moved	
Major Alterations and Date	
Level/Significance	
Source	Majorie Field, R. Musgrove
Style	Queen Anne
Boundary and Acreage Description	Bounded on north by Winter Street on south by Summer Street, on west by Thomas and Mary Babcock, on east by the Town of Bristol and Robert Hill — 28,000 sq. ft.
Comments	Well-preserved interior woodwork and fireplaces.
Surveyor	David Ruell
Surveyed On	1982

Photographer

Photo



Map

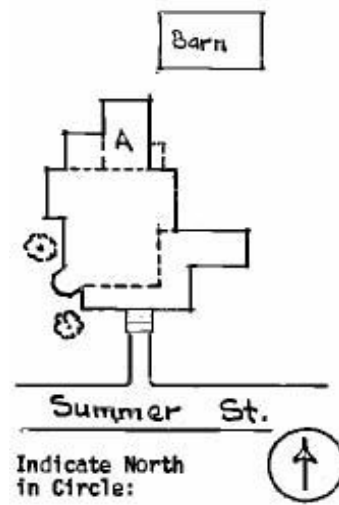

### A. Architectural Description

Architecture Style  
Building Type  
Number of Stories  
Dimensions

Queen Anne  
House  
2.5  
34 x 38

Bays	Irreg.
Architecture Form	Asymmetrical
Foundation	Cut granite block
Structure Type	Balloon frame
Wall Sheathing	Clapboards
Wall Ornamentation	Corner boards
Roof Type	Hip with cross gable
Roof Sheathing	Synthetic slate
Dormers/Cupolas	2 hip roof S&E/1 shed N
Roof Details	Widow's walk at peak of room
Number of Chimneys	3
Chimneys Location	Interior slope
Chimney Materials	Brick
Chimneys Description	Tall and plain
Gable End Eaves Treatment	Box cornice with frieze
Windows Placement	Irregular
Windows Shape	Rectangular
Windows Sash	1-Jan
Windows Surrounds	Usually a simple moulded lintel, some with further ornament - fans & panels
Main Entry Location	Center S
Main Entry Door	Wood w/large oval widow
Main Entry Surround: Flanked	1/2 sidelights (stained glass)
Main Entry Surround: Topped	Entablature
Main Entry Framed	
Number of other entries	1
Location of other entries	East (on porch)
Surrounds of other entries	Plain side trim. moulded lintel
Number of Porches/Hoods	2
Style/Roof Type	Veranda/modern open deck
Location of Porches/Hoods	S & E sides/W
Porches/Hoods Supports	Columns/wooden posts
Porches/Hoods: Other Features	S7E railing, base of lattice work and wood panels
Number of Bay Windows/Towers	
Bay Windows/Towers Location	W/SE cnr
Bay Windows/Towers Stories	2

Bay Windows/Towers Shape	3 sided/octagonal
Bay Windows/Towers Description	Paneled below 1st story & above 2nd story, shingled between, octagonal roof
Number of Ells/Wings	1
Stories (from map)	
Bays	
Ells/Wings Description	Gable roofed, clapboard ell with entry porch on east
Storefronts Configuration	
Storefronts Windows	
Storefronts Doors	
Storefronts Signage	
Storefronts Materials/Details	

## **B. Site Description/Surrounding Environment**

Number of related structures	2
Type of related structures	Barn & garage/wood drying shed
Description of related structures	Hip roof with central ventilator, clapboarded/shed roof, lattice work walls
Built Landscape Features	
Natural Landscape Features	Ornamental trees

## **C. Significance**

Architectural Importance/Integrity	An interesting late Queen Anne style house showing in some elements the influence of the Colonial Revival
Site Integrity	Contributes to historic character of street.
Historic Associations	Built for Henry Chandler Whipple, President of local Dodge-Davis Woolen Mills. Remained in family until 1961.

## **D. References**

References	Bristol Enterprise, July 18, 1904. Conversation - Marjorie Field
Map Data	